

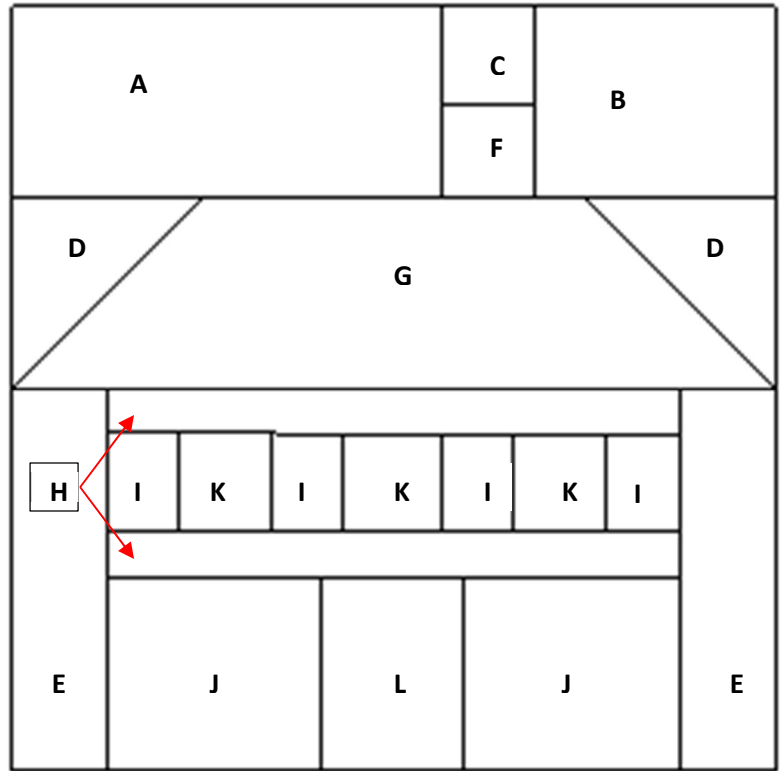

HOME SAFE HOME
4" X 4" & 8" X 8"
FIBRECHICK



READ entire pattern before sewing
Piecing Order

1. SEW C + F.
2. SEW & FLIP CORNERS D + G. **ROW 2**
3. SEW I + K + I + K + I + K + I.
4. SEW J + L + J

LAYOUT SEWN SECTIONS IN ROWS.

5. SEW A + CF + B = **ROW 1**
6. SEW H + IKIKIKI + H + JLJ.
SEW E TO SIDES OF PREVIOUSLY
SEWN SECTION. **ROW 3**

LAYOUT SEWN ROWS.

7. SEW ROW 1 ABOVE ROW 2.
8. SEW ROW 3 BELOW ROW 2.

MUG MAT OR HOT PAD:

COMPLETE BY ADDING BORDERS – FIRST TO THE SIDES AND NEXT TO THE TOP AND BOTTOM OF TO THE COMPLETED BLOCK. LAYER BATTING; BACKING & BLOCK RST. SEW AROUND THE OUTER EDGE LEAVING 2" TO 3" OPENING. TURN RIGHT SIDES OUT. QUILT (STITCH) IN THE DITCH. STITCH THE OPENING SHUT.

		4" x 4"	8" x 8"
Sky	A	1 - 1 1/2" X 2 3/4"	1 - 2 1/2" X 5"
	B	1 - 1 1/2" X 1 3/4"	1 - 2 1/2" X 3"
	C	1 - 1" X 1"	1 - 1 1/2" X 1 1/2"
	D	2 - 1 1/2" X 1 1/2"	2 - 2 1/2" X 2 1/2"
	E	2 - 1" X 2 1/2"	2 - 1 1/2" X 4 1/2"
Chimney	F	1 - 1" X 1"	1 - 1 1/2" X 1 1/2"
Roof	G	1 - 1 1/2" X 4 1/2"	1 - 2 1/2" X 8 1/2"
Walls	H	2 - 1" X 3 1/2"	2 - 1" X 6 1/2"
	I	4 - 7/8" X 1 1/2"	4 - 1 1/4" X 1 1/2"
	J	2 - 1 5/8" X 1 1/2"	2 - 2 1/2" X 2 3/4"
Windows	K	3 - 1" X 1"	3 - 1 1/2" X 1 1/2"
Door	L	1 - 1 1/4" X 1 1/2"	1 - 2" X 2 1/2"
Borders		2 - 1 1/4" x 4 1/2"	2 - 1 3/4" x 8 1/2"
		2 - 1 1/4" x 6"	2 - 1 3/4" x 11"

- All sewn seams are 1/4".
- Right Sides Together: RST

Please accept this pattern for your personal use.
The pattern is copyright protected. You may not copy or transfer the pattern in any format without express written permission from Kim Boaro. Copyright 2020